



DÉCOR DECK Installation and Care Guidelines

STORAGE & HANDLING

1. Keep factory applied covering on products until installed to protect against dirt and debris.
2. Cover decking with a light colored tarp before installing to minimize expansion and contraction and store on a flat leveled surface.
3. Do NOT stack bundles over 8 units high.
4. Use caution when using a forklift. Forks may damage the decking.
5. When using plastic banding (steel banding is not recommended), use corner protectors to prevent denting.

TOOLS

1. Décor Deck installation is comparable to wood or composite decking and the tools for installation are similar.
2. Battery operated or corded drill/screwdriver is recommended and self-feeding screw guns can also be used.
3. Do NOT nail Décor Deck.
4. Saw capable of miter cuts with a fine-toothed carbide tipped finish trim blade is recommended:
7 1/4" Ø 40 tooth minimum; 10" Ø 60 tooth minimum; 12" Ø 90 tooth minimum
5. Remember to wear safety glasses/goggles at all times!

IMPORTANT PLANNING AND PREPARATION

1. Décor Deck is not meant to be used for structural applications, supports, or beams
2. If using an existing support structure: Check that all joists are leveled, structurally sound, with no nails or screws protruding
3. Keep product orientated using a print-line as a guide.
4. Deck should be designed with enough clearance underneath to allow proper air circulation.
5. Correct joist spacing is required for proper installation
 - For best results, space 12" OC to minimize deflection
 - Do NOT exceed 16" on center spacing when installing planks perpendicular to joists
 - Do NOT exceed 12" on center spacing for commercial applications
 - Do NOT exceed 12" on center spacing when installing planks diagonal to joist, such as a herringbone pattern
6. When boards are installed end-to-end or with a splice joint, add double joists as needed to fasten deck boards securely.
7. Be sure all joists are leveled and crowned correctly. Décor Deck will conform to the contour of the substructure.
8. Use two screws for every joist and the maximum cantilevering distance is 1".

EXPANSION AND CONTRACTION

Décor Deck, when installed with two screws per joist, will have minimal expansion and contraction due to temperature changes. There will be no side-to-side movement and small end-to-end change; slight gaps may be noticed at the ends of boards or in spliced joints.

Approximate expansion and contraction for unattached deck boards based on 50° F temperature change: 12' = 3/16" / 16' = 1/4"

Provide proper ventilation to minimize expansion and contraction.

- Fasten boards after cutting as soon as possible.
- Boards must be fastened with two screws no more than 1/2" from ends
- Install boards together tightly at spliced joints and miters
- Always leave a 1/8" to 1/4" gap between decking and any structure (wall or post)
- Fasten ends of boards, splices, and abutments to building or secure to framing using two screws positioned within 1/2" of each board end or joint

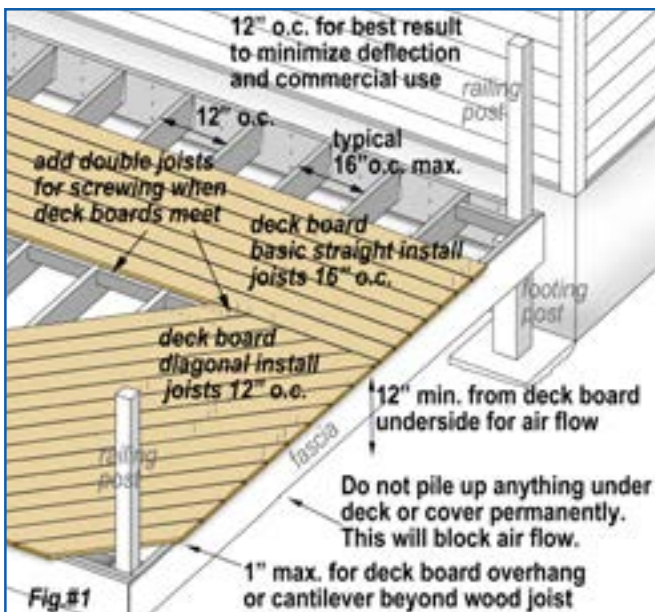

| CHART #1: JOIST SPACING | | | |
|-------------------------|-----------|-----------|-----------|
| | 90° angle | 30° angle | 45° angle |
| 100 PSF | 16" | 12" | 12" |

| CHART #2: DECK BOARD SPACING | | |
|------------------------------|-----------|--------------|
| Ambient Temperature | Butt ends | Side to Side |
| Below 32°F | 3/16" | 1/8" - 3/16" |
| Between 32°F and 75°F | 1/8" | 1/8" - 3/16" |
| Above 75°F | no space | 1/8" - 3/16" |

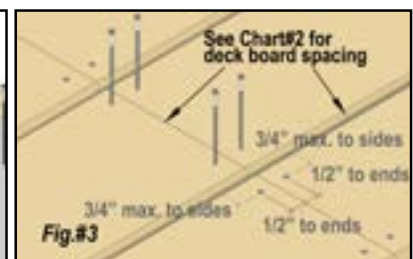
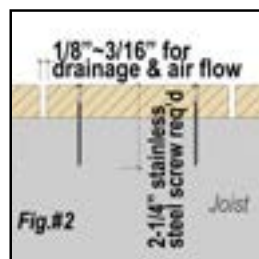



RECOMMENDED FASTENERS

Décor Deck is designed for durability and correct fasteners must be used to ensure the quality of the installation. High quality fasteners that meet the following requirements are recommended:

- Stainless Steel
- #7 Screw Size Minimum
- 2¼" Length Minimum
- Coastal applications near salt water require a 316 Stainless Steel screw or better
- Installing fasteners perpendicular to the deck is recommended.
- For side mount (hidden fastener) installation, use a positive fastening system within 1/2" of the end of each board for additional fastening strength. For any other fastener systems, contact Décor Deck Customer Service or the fastener manufacturer for compatibility.

NOTE:

- When installing Décor Deck with hidden fasteners, always use a sacrificial board against the side of the deck board. Never strike Décor Deck board directly with a hammer or rubber mallet.
- Dock and pier installations may have special fastening specifications as required by building codes. Check with authorities prior to installation.
- For best results, pre-drill holes when installing deck at 40° F or below.

STAIR TREADS

1. Build stairs per local building code requirements.
2. Install Décor Deck boards on stringers set no more than 12" OC.
3. Overhang should NOT exceed ½" beyond stringers.
4. Fasten deck board with two screws per stringer per board.

CARE & MAINTENANCE

Décor Deck, while very durable, must be maintained. The following recommendations will help keep the product looking its best:

- Periodic washing of the product using normal household products to remove dirt and debris
- **For rust removal:** A household toilet bowl cleaner is recommended.
- **For ice removal:** Products containing calcium chloride can be used without damage to the surface but may leave a white residue. This can be cleaned using the principles outlined above.
- **For snow removal:** Only use a plastic shovel. Any scratches from a shovel is not covered by the warranty.
- Some chemicals in sunscreen, insect repellent, and similar products can alter the surface of Décor Deck. Check product labels and consult with the manufacturer for compatibility with plastics before use.
- The best way to combat mold and mildew is by maintaining a clean and dry surface with proper air flow. Keep gaps between boards open and free of debris for drainage and airflow.
- AVOID using cleaners containing heavily discoloration chemicals. Always test the cleaner on a scrap piece of Décor Deck board.
- Décor Deck does NOT recommend the use of a pressure washer but use caution when operating a pressure washer. The improper use of a pressure washer could damage the decking surface and will void warranty coverage. If using a pressure washer, the recommended maximum washing pressure is 1400 PSI for Décor Deck. Spray in the direction of the grain pattern to avoid damages.
- NEVER use rubber backed items such as: mats, tarps, etc. for any extended amounts of time as these items may cause discoloration of the decking surface.

NOTE:

Cleaning products may slightly lighten the color of Décor Deck boards. Always test on a scrap piece of Décor Deck board.

WARNING:

Excessive heat build up from reflecting sunlight, especially reflected by low-emissivity (Low-E) glass, can potentially damage Décor Deck, since these surface temperatures may far exceed exposure to normal sunlight. Possible damage by such concentrated heat may include warping, sagging, surface discoloration, unusual weathering, and increased expansion and contraction.

Décor Deck is produced from a cellular foaming process and is 100% recyclable. The resin identification code (RIC) of polyvinyl chloride (PVC) according to the Society of Plastics Industry (SPI) is:



If recycling is not possible, disposal to landfills or incineration in accordance with governmental laws and regulations is considered safe.

For additional questions or concerns, please contact the Décor Deck Customer Service Team.

Décor Deck boards are specially formulated to very closely resemble real wood decking. As a result, there may be slight differences in color and grain pattern from board to board. This adds to the uniqueness of Décor Deck, and will in no way affect the performance of the product.